





£270,000

This three-bedroom terraced is positioned in a cul-de-sac location on the popular Rivers estate in Bletchley. The property comprises a kitchen/diner, lounge, three bedrooms and a family bathroom. The property further benefits from a private, low-maintenance rear garden and off-road parking for several vehicles.

Property Description

ENTRANCE PORCH

UPVC front door, window to front aspect. Door to lounge.

LOUNGE

Double glazed window to front aspect. Feature fireplace, radiator, sliding door to kitchen, stairs rising to first floor.

KITCHEN

Double glazed window to rear aspect. Fitted with a range of wall-mounted and floor standing units with rolled edge work surface over, composite sink unit with mixer tap over, space for: washing machine, cooker with extractor over, under counter fridge and freezer; part tiled walls, tiled floor, radiator, storage cupboard, sliding patio door to garden.

LANDING

Doors to bedrooms and bathroom, access to loft space.

BEDROOM ONE

Double glazed window to front aspect. Radiator, fitted wardrobes.

BEDROOM TWO

Double glazed window to rear aspect. Radiator.

BEDROOM THREE

Double glazed window to front aspect. Radiator, storage cupboard.

BATHROOM

Double glazed frosted window to rear aspect. Low level WC, pedestal wash hand basin, bath with power shower over, heated towel rail, tiled walls.

OUTSIDE

PARKING

Off-road parking for three vehicles.

FRONT GARDEN

Path to front door, shrub/hedge borders, gravel area.

REAR GARDEN

Decking area, patio area, rear gated access, shed to remain, enclosed by timber fence panelling.

GROUND FLOOR
372 sq.ft. (34.5 sq.m.) approx.

1ST FLOOR
350 sq.ft. (32.5 sq.m.) approx.

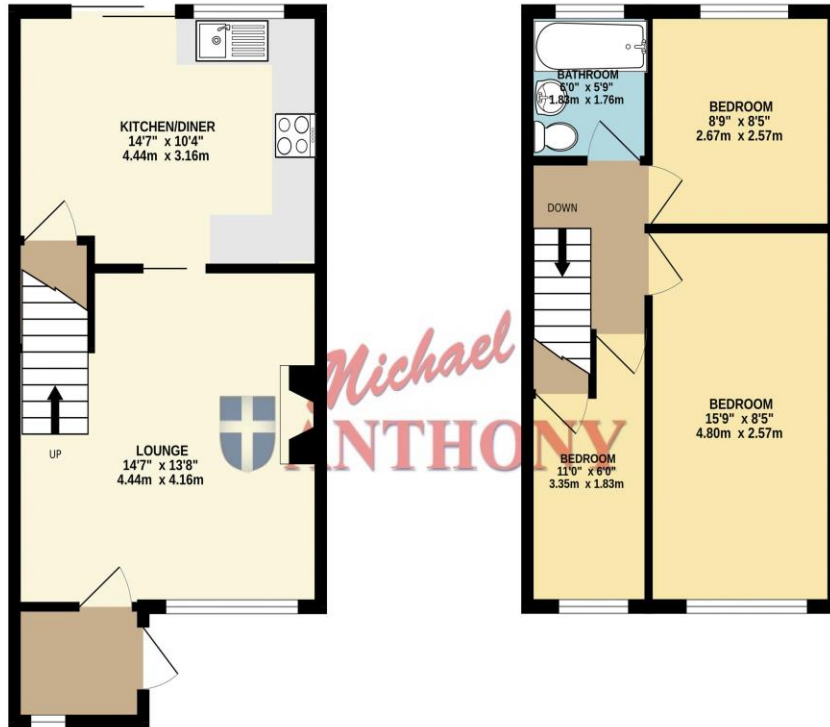

TOTAL FLOOR AREA: 721 sq.ft. (67.0 sq.m.) approx.

Whilst every attempt has been made to ensure the accuracy of the floorplan contained here, measurements of doors, windows, rooms and any other items are approximate and no responsibility is taken for any error, omission or mis-statement. This plan is for illustrative purposes only and should be used as such by any prospective purchaser. The services, systems and appliances shown have not been tested and no guarantee as to their operability or efficiency can be given.
Made with Metropix ©2023

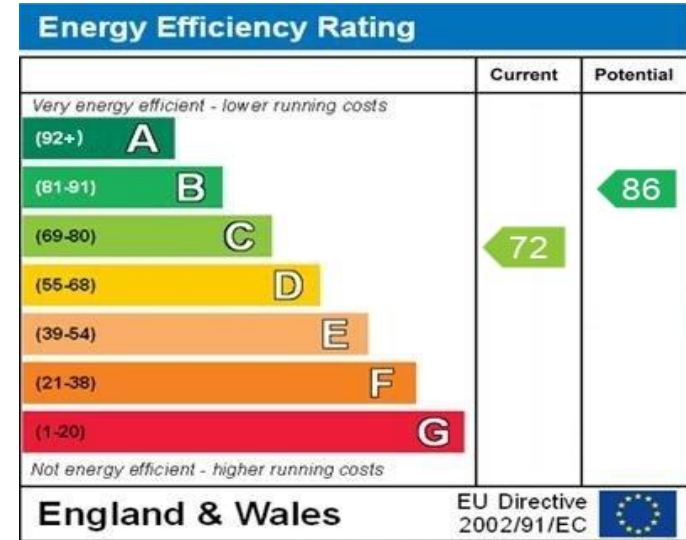

WWW.EPC4U.COM

MONEY LAUNDERING REGULATIONS 2017 intending purchasers will be asked to produce identification and proof of financial status when an offer is received. We would ask for your co-operation in order that there will be no delay in agreeing the sale.

THE CONSUMER PROTECTION REGULATIONS 2008 The Agent has not tested any apparatus, equipment, fixtures and fittings or services and so cannot verify that they are in working order or fit for the purpose. A Buyer is advised to obtain verification from their Solicitor or Surveyor. References to the Tenure of a Property are based on information supplied by the Seller. The Agent has not had sight of the title documents. A Buyer is advised to obtain verification from their Solicitor. You are advised to check the availability of this property before travelling any distance to view. We have taken every precaution to ensure that these details are accurate and not misleading. If there is any point which is of particular importance to you, please contact us and we will provide any information you require. This is advisable, particularly if you intend to travel some distance to view the property. The mention of any appliances and services within these details does not imply that they are in full and efficient working order. These particulars are in draft form awaiting Vendors confirmation of their accuracy. These details must therefore be taken as a guide only and approved details should be requested from the agents

190 Queensway Bletchley Milton Keynes MK2 2ST
01908 648 666 | bletchley@maea.co.uk